

La Cultura Cura: Healing Traditions and Models of Care with Latina/o Families & Communities



PRE-CONFERENCE WORKSHOPS

November 14, 2008

CONFERENCE

November 15-16, 2008

WESTIN SOUTH COAST PLAZA

Costa Mesa, California



¡Bienvenidos! Thank you for joining us!

TABLE OF CONTENTS

Welcome Message from Joseph M. Cervantes, Ph.D., ABPP President, National Latina/o Psychological Association	5
Biography: Oliva M. Espín Keynote Speaker, Saturday, November 15 th	6
Biography: Thomas A. Parham Keynote Speaker, Sunday, November 16 th	7
Pre-Conference Schedule, Friday November 14 th	8
Pre-Conference Morning Workshops Sessions (Topics & Abstracts)	9
Pre-Conference Afternoon Workshops Sessions (Topics & Abstracts)	10
Biographies: Pre-Conference Presenters	11-13
Biographies: Elder Panel	14-15
Conference Schedule at-a-Glance, Saturday, November 15 th	16-17
Saturday Morning Breakout Sessions (Topics & Room Assignments)	18-19
Saturday Mid-Day Breakout Sessions (Topics & Room Assignments)	20-21
Saturday Afternoon Breakout Sessions (Topics & Room Assignments)	22-24
Poster Session	25-28
Conference Schedule at-a-Glance, Sunday, November 16 th	29
Sunday Morning Breakout Sessions (Topics & Room Assignments)	30-31
Sunday Mid-Day Breakout Sessions (Topics & Room Assignments)	32-33
Sunday Special Events III—Roundtables (Topics & Room Assignments)	34
Sunday Special Events IV—Roundtables (Topics & Room Assignments)	35
NLPA 2008 Awards	36
Student Scholarship Awardees	37
NLPA Executive Committee	38
Acknowledgements	39
Sponsors	40-42
Notes	44-47
Map	48

CONFERENCE HIGHLIGHTS

Opening Ceremony—A call to the spirits to receive the blessings for this historic dialog,
Friday, November 14th, 5:00 pm—Front Lawn Area of Westin Hotel

Morning Vinyasa Yoga with Pia Kanekoa —Yoga is a an ancient practice that means union, which helps create a balance in body mind and spirit. Yoga opens your mind as well as creating a toned healthy body, improving your flexibility, health, well-being and overall state of relaxation. Breathing practices that help to calm the mind and energize the body. Vinyasa is a breath-synchronized movement.
Saturday and Sunday 6:00 am to 7:00 am—Executive Boardroom

Meditation Room, available throughout the conference for personal reflection and prayer (Executive Boardroom, 3rd floor).

Keynote Addresses: Oliva Espín, Ph.D.
“My Friendships” with Women Saints
Saturday

Thomas Parham, Ph.D.
Spirituality, Counseling and People of Color
Sunday

Elders Panel: Manuel Casas, Ph.D.
Marlene D. de Rios, Ph.D.

Poster Sessions: Saturday, 6:30 pm to 7:30 pm

Awards Ceremony, Dinner and Dance (Salsa): Saturday, 7:30 pm to Midnight—tickets are required and are still available. You may purchase tickets at check-in/registration.

NLPA Membership Town Hall Meeting: Sunday, 1:30 pm to 2:30 pm

Closing Ceremony: Sunday, 5:30 pm

The CE credits for this conference are offered by the California Psychological Association. The California Psychological Association is approved by the American Psychological Association to sponsor continuing education for psychologists. CPA maintains responsibility for this program and its content.

The California Psychological Association (CPA) is an approved provider of continuing education by the Board of Behavioral Sciences (BBS). The CPA provider number is PCE564.

The Board of Registered Nurses recognizes courses given by the California Psychological Association as hour for hour Category A CE.

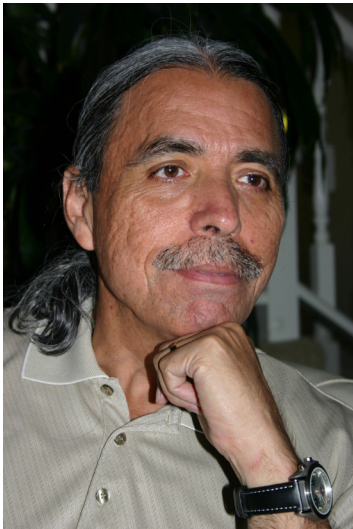

¡Bienvenidos!

NLPA Members & Conference Participants:

It is my pleasure to welcome you to the National Latina/o Psychological Association, our biennial conference with an exclusive focus on Latina/o psychology. We are a national association of scholars, faculty, researchers, practitioners, and students who have assembled for a common purpose- the education of our membership toward the understanding, advocating and service provision of our respective Latina/o families and communities. In particular, it is essential to learn and understand our culture, values, means of resilience, and

the indigenous practices leading to well-being. As such, a critical aspect of this heightened awareness and responsibility as professionals is to recognize an arena of importance that has not been sufficiently acknowledged by our profession: **Spirituality, Resilience and Coping.**

I dedicate this conference to the memories, support, and love provided to us by our partners, families, and significant community who have boosted our individual and collective evolution, and have affirmed our ability to be healers in our own right. I call in the healing energy and presence of all of our *Abuelas and Abuelos* to co-participate in this historic dialogue about spirituality, and what this means for all of us as scholars, as practitioners, as researchers and as students in training.

The conference presentations will interweave many themes that collectively make up the varied interests, research agendas, practice arenas, and advocacy on behalf of Latina/o communities. There will be many opportunities for meaningful dialogue which I encourage each of our members to engage in. The presentations will provide significant arenas of focus and discussion that will leave all of us with a renewed appetite for continued discovery, collaboration, and learning.

I hope that each of you as members of NLPA find this conference to be a meaningful dialogue toward the next step in your development as professionals. It is this community connectedness and our mission to serve our gente that I believe unites us towards the promotion of connectedness, wellness, and the affirming spirit of *La Familia* in all that we do.

Un abrazo a todos,

Joseph M. Cervantes, Ph.D., ABPP
President, National Latina/o Psychological Association
2007-2009

KEYNOTE SPEAKER
SATURDAY, NOVEMBER 15TH



OLIVA M. ESPÍN

Oliva M. Espín is Professor Emerita of Women's Studies at San Diego State University and the California School of Professional Psychology of Alliant International University. Dr. Espín's work has focused on therapy, research, and training on multicultural and feminist issues in psychology. She has published on psychotherapy with Latinas, immigrant and refugee women, women's sexuality across cultures, and other topics relevant to the psychology of women in multicultural contexts. Dr. Espín has been involved in governance of professional organizations such as the American Psychological Association and the Association for Women in Psychology. She is a member of the APA Committee for International Relations in Psychology. She is co-editor of *Refugee Women and their Mental Health: Shattered Societies, Shattered Lives*; *Feminist Reflections on Growth and Transformations: Asian-American Women in Therapy*; *Sin or Salvation: The Relationship between Sexuality and Spirituality in Psychotherapy* and author of *Latina Healers: Lives of Power and Tradition*; *Latina Realities: Essays on Healing, Migration, and Sexuality*; and *Women Crossing Boundaries: A Psychology of Immigration and Transformations of Sexuality*. This last book received an award from the Association for Women in Psychology. Among other awards and honors, Dr. Espín received the 1991 Award for Distinguished Professional Contribution to Public Service from the American Psychological Association, the 2001 Distinguished Career Award from the Association for Women in Psychology, and the 2006 Rosalée Weiss Award for Outstanding Leaders in Psychology from the American Psychological Foundation. She has received many other awards for her pioneer work in feminist and multicultural Psychology during several decades. Dr. Espín has recently turned her attention to the study of women saints from feminist perspectives and to the writing of memoir.

KEYNOTE SPEAKER SUNDAY, NOVEMBER 16TH

THOMAS A. PARHAM, PH.D.

Thomas A. Parham, Ph.D. is Assistant Vice Chancellor for Counseling and Health Services as well as an adjunct faculty member, at UCI. Dr. Parham received his Bachelor's degree in Social Ecology from the University of California, Irvine. He completed his Master's degree in Counseling Psychology at Washington University in St. Louis and received his Ph.D. in Counseling Psychology at Southern Illinois University at Carbondale. He is licensed to practice psychology in the state of California.



Dr. Parham is a Past President of the national Association of Black Psychologists. He is also a member of the American Counseling Association and the American Psychological Association. He is Past President of the Association for Multicultural Counseling and Development (a division of ACA). He is also a member of the Orange County Chapter of the 100 Black Men, where he has served as Chair of the Education Committee. He is the architect of the "Rites of Passage" program for the 100's "Passport to the Future" program and for the Los Angeles based "College Bound" program.

For the past twenty years, Dr. Parham has focused his research efforts in the area of psychological nigrescence and has authored many articles in the area. Research in the area of racial identity development remains his primary focus. He is the co-author of the 2nd and 3rd editions of a book entitled ***The Psychology of Blacks: An African Centered Perspective*** (Prentice Hall) and the author of a book entitled ***Psychological Storms: The African American Struggle for Identity*** (African American Images, 1993.) He is also the author of a book entitled ***Counseling Persons of African Descent*** (2002). He has also produced several videotapes on the topics of counseling African American clients and youth and violence which are available through Microtraining Associates, Inc. of North Amherst, MA.

Among his many honors and awards are included his selection as an American Psychological Association Minority Fellow in 1979 through 1982; the 1988 Research/Scholarship Award from the national Association of Black Psychologists; 1989 Research Achievement Award from the American Psychological Association's Minority Fellowship Program; election to Fellow status of Division 17 (Counseling Psychology) and Division 45 (Society for Psychological Study of Ethnic Minority Issues) of the American Psychological Association; and his election to the status of "Distinguished Psychologist" by the Association of Black Psychologists in 1998.

Friday, November 14th

Pre-Conference Schedule

8:00 am – 8:45 am	Continental Breakfast	Terrace Pavilion
9:00 am - noon	<p>Morning Workshops:</p> <p>A Hundred Ways to Keep One's Soul Alive: Exercises in Self-Care for Latina/o Professionals <i>Patricia Arredondo, Ed.D.</i> <i>University of Wisconsin, Milwaukee</i></p> <p>Ritual, Community and the Alchemical Vessel—a Transpersonal Experiential Journey Into Altered States and Healing <i>Richard Yensen Perez-Venero, Ph.D.</i> <i>Donna Dryer Perez-Venero, M.D., M.P.H., F.R.C.P.C.</i> <i>Cortes Island, British Colombia</i> <i>Canada</i></p> <p>Models of Resilience for Working Young Latina/o Children: Assessment and Treatment in the Early Intervention Program <i>Scott Mesh, Ph.D., CEO</i> <i>Los Ninos Services, New York</i></p>	<p>San Marcos</p> <p>San Juan</p> <p>San Felipe</p>
12:15 pm - 1:25 pm	Lunch (on your own)	
1:30 pm - 4:30 pm	<p>Afternoon Workshops:</p> <p>La Cultura Cura: Psychospiritual Guidelines in Counseling with Latina/o Families <i>Elena Flores, Ph.D., University of San Francisco</i> <i>Concepcion "Concha" Saucedo Martinez, Ph.D., Executive Director Emeritus/Co-Founder, Instituto Familiar de La Raza</i> <i>Estela Reyes Garcia, DMH, Executive Director of Instituto Familiar de La Raza</i></p> <p>Centralizing the Role of Espiritualidad in Latina/o Students' Educational Processes and Well-being: Theory, Research, and Practice Consultando el Espiritu Mestizo, Creando Consciencia de la Energia y Obteniendo Sanacion para Estudiantes Latin@s <i>Jeanett Castellanos, Ph.D., University of California, Irvine</i> <i>Alberta M. Gloria, Ph.D., University of Wisconsin, Madison</i></p>	<p>San Marcos</p> <p>San Juan</p>
4:30 pm to 4:45 pm	Break	
5:00 pm - 5:45 pm	Initiation of Conference and Community Ritual	Front Lawn Area of Westin Hotel
5:45 pm - 7:30 pm	Welcome Reception	Waterfall Terrace
7:30 pm	Dinner (on your own)	

Pre-Conference MORNING Workshop Sessions

9:00 am - noon

A Hundred Ways to Keep One's Soul Alive: Exercises in Self-Care for Latina/o Professionals

Presented by: Patricia Arredondo, Ed.D., University of Wisconsin, Milwaukee

Abstract:

The pace of daily life and myriad of personal and professional demands and pressures can put the most productive individual a little off-balance. For Latina/os and our allies working in the multicultural arena, culturally insensitive situations may introduce challenges to one's credentials, beliefs, and priorities. Comments or issues that some days roll off our back may seem insurmountable on other days. For the professional and student, it is necessary to anticipate responses to stress, unhappiness, and frustration. Above all, one must preserve one's integrity in the midst of tough situations. Group discussion will address individual situations emphasizing harmonia y buena salud.

Ritual, Community and the Alchemical Vessel—A Transpersonal Experiential Journey Into Altered States and Healing

Presented by: Richard Yensen Perez-Venero, Ph.D.

Donna Dryer Perez-Venero, M.D., MPH, FRCPC, Cortes Island, British Columbia, Canada

Abstract:

We will journey together, through ritual, breathwork, poetry and sensory overload on a mythic quest for healing and renewal. This training experience will provide illustration of the techniques we have developed in over 35 years of work with intense altered states of consciousness in psychotherapy.

Models of Resilience for Working Young Latina/o Children: Assessment and Treatment in the Early Intervention Program

Presented by: Scott Mesh, Ph.D., CEO, Los Ninos Services, New York

Abstract:

Learn the essentials of psychological and developmental assessment, including assessing autism in the youngest children. The Early Intervention Program (EIP) is now entrenched in North America and many developing countries. There is a great need for competent psychologists to perform these assessments, but few have this specialized training. This workshop will provide essential information to help one begin to develop competence in this subspecialty. By learning the unique aspects of the EI program, and working with babies and toddlers, the bilingual psychologist can gain a wonderful skill that is highly valued. Essential topics to be reviewed include: overview of the EIP regulations and philosophy that affect the evaluation process, bilingual issues, use of appropriate tests, the interview process, effective techniques in working with the young child, understanding "parents as partners", keys to successful report writing, and assessing autism. Effective evaluations lead to appropriate services at the earliest ages which is so critical, especially for children on the autistic spectrum. Videos will illustrate techniques as well as different developmental disabilities. This workshop will provide a detailed introduction to key areas of this subspecialty.

Pre-Conference AFTERNOON Workshops Sessions 1:30 pm - 4:30 pm

La Cultura Cura: Psychospiritual Guidelines in Counseling with Latina/o Families

Presented by: Elena Flores, Ph.D., University of San Francisco and

Concepcion "Concha" Saucedo Martinez, Ph.D., Executive Director Emeritus/Co-Founder, Instituto Familiar de La Raza and Estela Reyes Garcia, DMH, Executive Director of Instituto Familiar de La Raza

Abstract:

Instituto Familiar de la Raza is a community-based multi-service center that provides mental health and social services to Chicanos/Latinos in the Mission district of San Francisco, California. Instituto utilizes best practices from indigenous, conventional, and complimentary interventions in offering psychospiritual mental health services to families and the community. Instituto has been in the forefront of drawing upon the wisdom and knowledge found in traditional indigenous healing practices. Instituto uses the symbol, the Ollin or movimiento (movement), spirit, and life, which are dynamic qualities inherent in all human beings and represent a movement del corazon hacia otros (of the heart toward others). We are honored to share our psychospiritual healing approach to working with families in the Chicano/Latino community.

In this workshop, it is our intention to enhance cultural knowledge and personal awareness of the importance of our indigenous cosmology to the mental health of our Chicano/Latino families. We will use the CALMECAC process, a teaching process that utilizes experiential, didactic, reflection, and dialogue methods to engage participants in knowing and experiencing the concepts. Through this process, we discuss and experience indigenous spiritual values and concepts central to healing and health. We present psychospiritual interventions and healing practices that we have used to help families, groups, and the community we serve. Finally, we believe that this learning process will assist participants to integrate indigenous psychospiritual concepts with interventions in their own practice. Participants are asked to bring something of value to them or an offering to place on an altar.

Centralizing the Role of Espiritualidad in Latina/o Students' Educational Processes and Well-being: Theory, Research, and Practice

Presented by: Jeanett Castellanos, Ph.D., University of California Irvine and Alberta M. Gloria, Ph.D., University of Wisconsin, Madison

Consultando el Espiritu Mestizo, Creando Consciencia de la Energia y Obteniendo Sanacion para Estudiantes Latina/os

A three-hour interactive workshop, the experience will offer higher education personnel, researchers, students, and community members an overview of the role of spirituality and connection to educational processes for Latina/o students in high school, community college, four-year institutions, and graduate school. The goal of the workshop is to increase awareness, knowledge, and skills of practitioners and researchers about Latina/o students' coping, spirituality, and well-being. Combination of these critical components of competence will assist attendees to have a deeper understanding of spiritual practices, cultural values, and their subsequent impact on overall educational well-being for Latina/o students. In doing so, the presentation takes an educational pipeline approach in discussing the extant literature regarding Latina/o students' educational processes in the context of coping, religion, folk beliefs, and spirituality. In addition, issues of college adjustment and family dynamics will be addressed. Specific focus will be placed on cultural coping means, community and family support, and religious, indigenous, and spiritual practices. Guiding questions of the presentation will be, "What are Latina/os students' primary practices in the context of difficult educational life challenges and what role does spirituality and the sixth and seventh dimension play in their daily lives?" and "How do Latina/os' spiritual perspectives influence their physical, emotional, mental, and spiritual (PEMS) wellness and their overall educational well-being?" Application to specific examples will be provided to elucidate Latina/o students' spiritual beliefs, cultural values, and daily practices and their roles in educational persistence and success. Translation of information within practice and research venues will be provided to enhance practical interactions (e.g., advising or counseling sessions) and processes, well-being outcomes, and research directives. Participants will receive resources (i.e., handouts, references, and articles) used in the presentation. The use of media, poetry, and case scenarios will be incorporated to elucidate presentation constructs.

Pre-Conference Speakers



Patricia Arredondo, Ed.D., has dedicated her career to addressing four primary areas in psychology and counseling: immigrants' transitions and change and identity development, multicultural competencies and guidelines, Latina/o psychology, and organizational diversity management. Her publications and international presentations in the broad-based, multicultural psychology arena have led to numerous distinctions. Patricia was named a *Living Legend* by the American Counseling Association in 2005 and is a Fellow of Divisions 17 and 45 of the American Psychological Association. Patricia received an honorary doctorate of Humane Letters from the University of San Diego in 1998—recognition for her extensive contributions to multicultural counseling.

Currently, Patricia is the Associate Vice Chancellor for Academic Affairs and Interim Dean for the School of Continuing Education for the University of Wisconsin-Milwaukee. She is also a Professor in the Department of Educational Psychology. Patricia is a past

president of the APA Division 45, National Latina/o Psychological Association, Association for Multicultural Counseling and Development, and the American Counseling Association. She is a licensed psychologist and of Mexican-American heritage.



Richard Yensen Pérez-Venero, Ph.D. is a Panmanian/American, California Licensed Psychologist living on Cortez Island in British Columbia Canada. He is a graduate of the University of California, Irvine. As a research fellow Dr. Yensen conducted multiple psychedelic drug psychotherapy studies at the Maryland Psychiatric Research Center (MPRC) between 1972 and 1976. The MPRC was on the grounds of Spring Grove State Hospital in Maryland and was the last federally funded major psychedelic research program in the U.S. Dr. Stanislav Grof was a mentor during that time. He also worked with Dr. Salvador Roquet and the mushroom curandera, Maria Sabina on numerous expeditions throughout

Mexico and Huautla de Jimenez, Oaxaca between 1972 and 1985. After the MPRC's psychedelic research was shut down in 1976, Dr. Yensen created a form of psychotherapy (Perceptual Affective Therapy) using altered states of consciousness and music, which synthesized the psychedelic, shamanistic, and psychosynthesis approaches. In 1989 he founded the Orenda Institute with his wife, Dr. Donna Dryer, and renewed the Investigational New Drug (IND) permit for LSD first obtained by Dr. Albert A. Kurland when he was the director of the MPRC. Under this IND, two LSD protocols were approved by the U.S. Food and Drug Administration (FDA): one, in 1991, was for people with addictions and the second, in 1993, was for people with a diagnosis of cancer. Both protocols were placed on "clinical hold" by the FDA and the stop orders were never lifted, so the clinical work was not completed. Dr. Yensen continues to teach training courses in altered states of consciousness in psychotherapy in Barcelona, Spain where his book, *Hacia Una Medicina Psiquedelica: Reflexiones sobre el uso de enteógenos en psicoterapia*, was published in 1998. For the last 23 years Dr. Yensen and Dr. Dryer have consolidated their work into Heart of the Shaman experiential intensive workshops. (see www.orenda.org for more information)

Donna Dryer Pérez-Venero, M.D., M.P.H., F.R.C.P.C. is a California licensed psychiatrist living and practicing on Cortez Island in British Columbia Canada. She is a transpersonal psychiatrist who did her psychiatric training at Harvard University's Cambridge City Hospital under the supervision of Dr. Dan Brown, Dr. Jack Engler, and Dr. Myron Sharif. She spent five months during her fourth year of medical school in Thailand working with Dr. Vichai Poshyachinda studying addiction medicine in Bangkok and the shamans of the Hmong hill tribes. In 1985, she met Dr. Richard Yensen and in 1989 they renewed the LSD research begun at the MPRC with Dr. Al Kurland (see Yensen bio). Presently, they have moved the Orenda Institute to Cortez Island, B.C. where they continue to develop the Heart of the Shaman courses and training in the uses of altered states of consciousness for psychological healing. (www.orenda.org)

Pre-Conference Speakers (continued)



Scott Mesh, Ph.D., is a bilingual clinical psychologist and Executive Director of Los Niños Services. He is an international speaker on bilingual early childhood assessment and specializes in developmental and psychological assessment of young Spanish-speaking children. He has served as an adjunct professor at Long Island University, Yeshiva University, Queens College, and the New York Medical College. He is the co-author, with Dr. Joanne Loeb, of “A Practical Guide to Early Childhood Assessment.” He has personally evaluated over 4,000 children including many on the autistic spectrum. See www.losninos.com for further information.



Edita Diaz, M.S.Ed., is a bilingual school psychologist, the Co-Founder and Director of Operations of Los Niños Services. She has over 20 years of experience working with children under 5 in regular day care, preschool, Head Start, special education and the Early Intervention Program. As an Hispanic immigrant who came to the United States at age 18, she has a wealth of personal and professional knowledge about the acculturation process. She has evaluated hundreds of young children with a variety of developmental disabilities and been supervisor of large evaluation departments. See www.losninos.com for further information.



Elena Flores, Ph.D. is a Chicana, Mexican American clinical psychologist, Associate Professor in the Counseling Psychology Department, School of Education, University of San Francisco. She has several years experience providing mental health services to the Chicano/Latino community, including psychotherapy, consultation, and training, and conducts research on Mexican American family functioning and Latino adolescent sexuality.



Concepcion “Concha” Saucedo Martinez, Ph.D. is a Mexicana-Yaqui-Chicana, psychologist, and traditional healer. She is a grandmother of seven, Executive Director Emeritus and co-founder of Instituto Familiar de la Raza, and a community activist for 40 years. She has focused her life work on integrating indigenous spiritual practices with mental health services for the healing of youth, families, and community.

Pre-Conference Speakers (continued)



Dr. Jeanett Castellanos currently serves as the Director for the Social Science Academic Resource Center in the School of Social Sciences at the University of California Irvine. Dr. Castellanos also serves as a Lecturer for the Department of Social Sciences and the Chicano/Latino Studies Program. She holds a baccalaureate degree from the University of California Irvine, Masters of Education specializing in Counseling, and a Ph.D. in Education from Washington State University. Her research focuses on the college experience of racial and ethnic minority students and the psychosociocultural factors that affect their retention. Other research interests include Latina/o student coping, spirituality, and wellness. Dr. Castellanos received the Samuel Turner Mentor Award from the American Psychological Association from Division 12 for her outstanding commitment to minority education and research in 2007. Dr. Castellanos has co-edited two books, *The Majority in the Minority: Expanding the Representation of Latina/o Faculty, Administrators and Students in Higher Education* (2003), and "Pathway to the Latina/o Ph.D.: Abriendo Camino (2006)," both which address Latina/o student experiences in higher education. Most recently, Castellanos co-authored a chapter on education and training about Latinas/os and their communities in the Council of National Psychological Associations for the Advancement of Ethnic Minority Interests (2007). She is a member of the American Psychological Association (APA), the National Latina/o Psychological Association (NLPA), and the American Association of Hispanics in Higher Education (AAHHE).



Alberta M. Gloria received her doctorate in Counseling Psychology from Arizona State University and is a Professor in the Department of Counseling Psychology. She served as the Director of the Chican@ Latin@ Studies Program at the University of Wisconsin-Madison from 2006 to 2008. Her primary research interests include psychosociocultural factors for Latina/o and other racial/ethnic students in higher education. Addressing issues of cultural congruity, educational and social coping supports, and academic well-being, her work has appeared in journals such as *Cultural Diversity and Ethnic Minority Psychology*, *Hispanic Journal of Behavioral Sciences*, and *Journal of College Student Personnel*. An active member of the American Psychological Association, she is Past -Chair for the Section for Ethnic and Racial Diversity for Division 17 (Society of Counseling Psychology), past Member-at-Large for Division 45 (Psychological Study of Ethnic Minority Issues), and past President of the Latina/Hispanic Women's Concerns for Division 35 (Society for the Psychology of Women). She was awarded the 2002 Emerging Professional Award from Division 45 of the APA for outstanding early career contributions in promoting ethnic minority issues in the field of psychology and in 2003, Dr. Gloria received the Kenneth and Mamie Clark Award from the American Psychological Association of Graduate Students for her contributions to the professional development of ethnic minority graduate students. She co-edited a book entitled, "Pathway to the Latina/o Ph.D.: Abriendo Caminos," which addresses the experiences of Latina/o students' pursuing higher education. She was the recipient of the 2007 Woman of Color of the Year in Education for the UW-Madison campus and the recipient of the 2007 Charles and Shirley Thomas Award for mentoring from the Division 45 of the American Psychological Association. Most recently she was awarded the 2008 Outstanding Latina/o Faculty Member (Research Institutions) by the American Association of Hispanics in Higher Education. For the 2008-2009 academic year, she will conduct a research fellowship at Marquette University.

ELDER PANEL



J. Manuel Casas, Ph.D.

J. Manuel Casas, Ph.D., received his doctorate from Stanford University with a specialization in counseling psychology. Currently, he is a professor in the Counseling, Clinical, and School Psychology Department at the University of California, Santa Barbara. He has published extensively (over 130 publications). He is the co-author of the *Handbook of Racial/Ethnic Minority Counseling Research* (Charles C. Thomas, 1991) and is one of the editors of both editions of the *Handbook of Multicultural Counseling* (Sage, 1995, 2001). His most recent research and publication endeavors have focused on Hispanic families and children who are at risk for experiencing educational and psychosocial problems, including drug and alcohol abuse. His research in this area gives special attention to the resiliency factors that can help Hispanic families avoid or overcome such problems. His expertise and that of his colleagues in this area have brought numerous research grants to the campus and the community. He also serves as a consultant to various private and governmental agencies and organizations. He has served on numerous editorial boards including *The Counseling Psychologist*, *Hispanic Journal of Behavioral Sciences*, *Journal of Multicultural Counseling and Development*, and *Cultural Diversity and Ethnic Minority Psychology*.

Dr. Casas served as the first chairperson of Division's 17 Committee on Ethnic Minority Affairs. Since then, he has been honored as a fellow of APA Division 17 (Counseling Psychology), Division 45 (Society for the Study of Ethnic Minority Issues), and of the Rockefeller Foundation. He received the California Association of School Psychologists research award, the Distinguished Contributions to Latino Psychologists award (given by the National Latino(a) Psychological Association), and the Distinguished Elders award given by National Multicultural Conference and Summit). He is also the recipient of numerous grants related to research on drug and alcohol use, high-risk students, and public policy related to Latinas/os. For all of these accomplishments, Dr. Casas was honored as a distinguished scholar in the field of Chicana/o Psychology by the Julian Samora Research Institute at the 1998 Innovations in Chicana/o Psychology conference at Michigan State University.

ELDER PANEL

Marlene D. De Rios, Ph.D.



MARLENE D. DE RIOS, PH.D. DR. MARLENE D. DE RIOS is a medical anthropologist and licensed Marriage, Family Therapist. She is Professor Emerita of Anthropology at California State University, Fullerton and Associate Clinical Professor of Psychiatry & Human Behavior at the University of California, Irvine. She is in private practice in Fullerton, California. Dr. de Rios is an authority on plant hallucinogens across the globe and historically. Her book, *Brief Psychotherapy with the Latino Immigrant Client* has been well reviewed in psychological and psychiatric journals. De Rios has applied lessons from shamanic healing that she studied in the Peruvian Amazon and coast to develop culturally resonant psychological interventions for Spanish-speaking immigrants to Southern California. She is also the author of *Amazon Healer: The Life and times of an Urban Shaman*, focusing on the late don Hilde, an ayahuasca healer in the Peruvian Amazon.

Saturday, November 15th Conference Schedule at-a-Glance

6:00 am – 7:00 am	Morning Vinyasa Yoga (all levels) with Pia Kanekoa	Executive Board Rm.
8:00 am – 8:45 am	Continental Breakfast	Plaza Ballroom
8:00 am – 8:45 am	Student Breakfast Meeting	Mesa Verde
8:00 am – 5:00 pm	Exhibit Hall Open	Terrace Pavilion
8:45 am – 9:45 am	<p>Opening Ceremony/Conference Initiation Welcoming Remarks Jose M. Cervantes, Ph.D., ABPP President, NLPA Introduction of VIPs</p> <p>Jo Linder Crow, Ph.D. Executive Director, California Psychological Association</p> <p>Miguel Gallardo, Ph.D. President, California Psychological Association</p> <p>James Bray, Ph.D. President-Elect, American Psychological Association</p> <p>Bertha Holliday, Ph.D. Director, Office of Ethnic Minority Affairs American Psychological Association</p>	Plaza Ballroom
9:45 am – 10:45 am	<p>Special Event I La Cultura Cura: Developing a Psychotherapeutic Dimension to the Healing of Relationships, Elena Flores, Ph.D. Concepcion “Concha” Saucedo Martinez, Ph.D.</p>	Plaza Ballroom
10:45 am – 11:00 am	Break	
11:00 am – 12:15 pm	Morning Breakout Sessions (refer to pages 18-19 for topics and room assignments)	
12:15 pm – 12:30 pm	Break/Lunch Check-In	Plaza Ballroom
12:30 pm – 1:45 pm	<p>Lunch Blessing and Introduction of incoming NLPA President, Ed Delgado-Romero, Ph.D. Keynote Address, “My Friendships” with Woman Saints Oliva M. Espin, Ph.D. Professor Emerita Department of Women's Studies San Diego State University</p>	Plaza Ballroom
2:00 pm – 3:15 pm	Mid-Day Breakout Sessions (refer to pages 20-21 for topics and room assignments)	
3:15 pm – 3:30 pm	Break	

Saturday, November 15th

Conference Schedule at-a-Glance (CONTINUED)

3:30 pm – 4:45 pm	Afternoon Breakout Sessions (refer to pages 22-24 for topics and room assignments)	
4:45 pm – 5:00 pm	Break	
5:00 pm – 6:00 pm	Elder Panel (refer to pages 14-15 for more information)	Plaza Ballroom
6:00 pm – 6:30 pm	Break	
6:30 pm – 7:30 pm	Poster Session/Social Hour (refer to pages 25-28 for topics)	Terrace Pavilion
7:30 pm – 9:30 p.m.	*Gala: Celebrando Nuestros Logros Dinner & Awards Ceremony (tickets required)	Plaza Ballroom
9:45 pm – Midnight	NLPA Dance Charangoa—Salsa	Plaza Ballroom

*Tickets for the gala are still available. Tickets are \$30 and include dinner and dancing. Tickets may be purchased at conference registration located on the first floor just outside of the ballroom).

Saturday MORNING Breakout Sessions 11:00 am - 12:15 pm

SYM: Symposium

RT: Roundtable

SYM-ST: Symposium-Student Track

RT-ST: Roundtable-Student Track

PR: Paper

RT-Workshop: Roundtable-Workshop

SYM-ST	The Publication Process	Patricia Arredondo, Alberta Gloria, & Edward Delgado-Romero	Mesa Verde
SYM-ST	Getting into Graduate School	Roseanne Illes, Nathalie Vallieres, & Melanie Domenech Rodriguez	Lido
PR	<ol style="list-style-type: none"> 1. The Relation Between Perceived Institutional & Inter-group Discrimination and Latina/o Adolescent Well-Being 2. Adolescent Resilience Model for Discrimination: Protective Effects of Ethnic Identity Development 3. Acculturative Stressors, Coping, and Latino Depression: The Role of Gender and Generational Status 	<ol style="list-style-type: none"> 1. Kristine M. Molina & Ramaswami Mahalingam 2. Andrea J. Romero, Lisa M. Edwards, & Stephanie Fryberg 3. Lucas Torres 	China Cove
PR	<ol style="list-style-type: none"> 1. Adoption of Sociocultural Attitudes about Appearance and Individualism/Collectivism in Latina and Latina-American College Women 2. Sociocultural Issues Related to Body Image and Eating Issues in Mexican American Women 3. Latinos Learning Healthy Eating Habits: The Importance of La Familia in Treatment 	<ol style="list-style-type: none"> 1. Elizabeth D. Cordero, Elizabeth Scarpetta, & Emma Martinez 2. Yolanda E. Gamboa 3. Maria Antonia Rodriguez & Sunna Jung 	Monarch Bay
PR	<ol style="list-style-type: none"> 1. Organizational Strategies to Reduce Service Disparities among Latina/os 2. Emic and etic perspectives: Is there a room for dialogue? 3. Hispanic/Latino Race and Ethnicity in Counseling Psychology Research: A 15-Year Review 	<ol style="list-style-type: none"> 1. Ignacio David Acevedo & Mario Hernandez 2. Ana A. L. Baumann & Melanie Domenech Rodriguez 3. Silvia L. Mazzula & Rodolfo Victoria 	San Diego

Saturday MORNING Breakout Sessions (CONTINUED)

11:00 am - 12:15 pm

SYM: Symposium

RT: Roundtable

SYM-ST: Symposium-Student Track

RT-ST: Roundtable-Student Track

PR: Paper

RT-Workshop: Roundtable-Workshop

Saturday MID-DAY Breakout Sessions 2:00 pm - 3:15 pm

SYM: Symposium

RT: Roundtable

SYM-ST: Symposium-Student Track

RT-ST: Roundtable-Student Track

PR: Paper

RT-Workshop: Roundtable-Workshop

SYM-ST	Working for Social Justice: How to Become an Agent of Change	Patricia Arredondo & Azara Santiago-Rivera	Mesa Verde
SYM-ST	Looking Beyond Graduation: Different Career Paths of Psychologists	Lisa M. Edwards, Rachel L. Navarro, & Lynda Field	Lido
PR	<ol style="list-style-type: none"> 1. Latino Cultural Values, Parenting Practices, and Child Mental Health in first-generation Latina/o Families 2. Psychological Interventions for Single Latina Mothers and Families 3. A Comprehensive Domestic Violence Family Intervention for Latinas, Latinos, and their Children: An Ecological Approach 	<ol style="list-style-type: none"> 1. Melissa Renee Donovanick & Melanie Domenech Rodriguez 2. Araceli Mejia, Maritza Gallardo-Cooper, G. Miguel Arciniega, & Elizabeth Poloskov 3. Josephine Vasquez Serrata & Julia Perilla 	China Cove
PR	<ol style="list-style-type: none"> 1. Beyond Translation: Encontrando la Voz Latina 2. The Integration of Healing Drumming Circles in Group and Community Healing 3. Narrative Therapy as a Theoretical Foundation for Honoring and Incorporating Latina/o Culture in Counseling 	<ol style="list-style-type: none"> 1. Victoria Elena Frehe 2. Sal Nunez 3. Manuel X. Zamarripa 	Monarch Bay
SYM	Culturally Appropriate Public Education on Mental Health with Latinos	Henry Acosta	San Diego
SYM	Adjustments and Transitions for Immigrant Latinos <ol style="list-style-type: none"> 1. The Mental Health of Undocumented Latino Immigrants 2. Integration Efforts of Latino Immigrants in Three Rural Communities in the Midwest 3. Therapeutic Implications of Working with Documented and Undocumented Latino Immigrants 	Chair: Lucila Ramos-Sanchez <ol style="list-style-type: none"> 1. Lucila Ramos-Sanchez 2. Lisa Y. Flores, Corinne B. Valdivia, Stephen C. Jeanetta, & Domingo Martinez 3. Elizabeth D. Fraga 	San Pedro
SYM	Impact of Language and Cultural Competence Programs on Professional Identity and Competence of Psychologists-in-Training.	Leila Durr, Kee J.E. Straits, & Josefina Irigoyen	San Felipe

Saturday MID-DAY Breakout Sessions (CONTINUED)

2:00 pm - 3:15 pm

SYM: Symposium

RT: Roundtable

SYM-ST: Symposium-Student Track

RT-ST: Roundtable-Student Track

PR: Paper

RT-Workshop: Roundtable-Workshop

SYM	<p>Sanando el Corazón: The Design, Pilot-testing, and Community Experiences of an Integrative Depression Treatment Approach for Spanish-speaking Immigrant Women with Comorbid trauma</p> <ol style="list-style-type: none"> 1. Cultural and Theoretical Integration of a Cognitive-Behavioral Intervention for Depression: The Sanando el Corazón group 2. Working within a Community Setting: Vignettes, Participant Feedback, and Clinician Perspective 3. Challenges of Conducting a Pilot Study in a Community Setting: Preliminary Data from the Sanando El Corazón Group 	<p>Chair: Alinne Z. Barrera</p> <ol style="list-style-type: none"> 1. Vilma Entrenas-Yépez, Ingrid Zimmermann de la Torre, & Alinne Z. Barrera 2. Ingrid Zimmermann de la Torre, Vilma Entrenas-Yépez, & Alinne Z. Barrera 3. Alinne Z. Barrera, Vilma Entrenas-Yépez, & Ingrid Zimmermann de la Torre 	San Marcos
SYM	<p>Cancer among Latina Women: The Cultural Context of Prevention and Survivorship</p> <ol style="list-style-type: none"> 1. Latino College Students' Sexual Health Beliefs about HPV 2. Life is Very Precious: Conceptualizing the Experiences of Latina Breast Cancer Survivors 3. Suddenly, a Carriage Appears: Social Support Needs of Latina Breast Cancer Survivors 	<p>Chair: Lydia P. Buki Discussant: Lisa Sanchez-Johnsen</p> <ol style="list-style-type: none"> 1. Tiffany A. Schiffner & Lydia P. Buki 2. Lydia P. Buki 3. Nallely Galvan, Lydia P. Buki, & D. Marcela Garces 	San Juan
SYM	<p>First Generation Latino/a College Student Experiences of Support and Stress: College Assistance and Migrant Program Students Share their Experience</p> <ol style="list-style-type: none"> 1. College Assistance Migrant Program (CAMP) at California State University Sacramento (CSUS): An Introduction and Overview 2. First Generation Latino/Hispanic College Students: Stress, Supports and Resources 3. The experience of a Latina First Generation College Student: Highlights of the Challenges and Stressors During College and the Value of Key Supports 	<p>Chair: Kathryn Ecklund</p> <ol style="list-style-type: none"> 1. Viridiana Diaz 2. Kathryn Ecklund 3. Adriana Cervantes 	San Carlos

Saturday AFTERNOON Breakout Sessions 3:30 pm - 4:45 pm

SYM: Symposium

RT: Roundtable

SYM-ST: Symposium-Student Track

RT-ST: Roundtable-Student Track

PR: Paper

RT-Workshop: Roundtable-Workshop

SYM-ST	Internship Presentation	Diana Naranjo, Tiffany Schiffner, & Dean Coffey	Mesa Verde
SYM-ST	Dissertation Process from Start to Finish	Shannon Chavez-Korell, Azara Santiago-Rivera, & Marie Miville	Lido
PR	<ol style="list-style-type: none"> 1. Longitudinal Factors Impacting Latina/o Academic Persistence in College 2. ExCEL- A Culturally Relevant Clinical Intervention Program to promote the Retention and Success of Latino/a College Students 3. Is There a Sustaining Effect After the Completion of a Mentoring Program? An Evaluative Study 	<ol style="list-style-type: none"> 1. Veronica Bordes, Patricia Arredondo, & Sharon Robinson Kurpius 2. Lideth Ortega-Villalobos & Mark A. Stevens 3. Jennipha-Lauren Nielson, Jason Wang, & Sonia Legaspi 	China Cove
PR	<ol style="list-style-type: none"> 1. The History and Current Relevance of Chicana/o Psychology 2. The Psychology of Undocumented Immigration: Preliminary Findings from a Comprehensive Review 3. Psychosocial Stressors of Undocumented Latino College Students 	<ol style="list-style-type: none"> 1. Manuel X. Zamarripa 2. Karina Ramos, Ignacio David Acevedo- Polakovich, Melanie Domenech Rodriguez, & Chad Walkenhorst 3. Lucila Ramos-Sanchez 	Monarch Bay
PR	<ol style="list-style-type: none"> 1. Desafiando todo Pronóstico: Developing a Prevention Program to Enhance Resiliency in Latino Children 2. Resilience and Risk: The Cultural Shaping of Close Relationships and Latina Pregnancy Outcomes 3. Latino Couples Parent Education as a Means to Prevent and Treat Intimate Partner Violence: Involving Men in the Dialogue 	<ol style="list-style-type: none"> 1. Maren Westphal & Johanna Rengifo- Nevarez 2. Belinda Campos 3. Christauria G. Welland 	San Diego

Saturday AFTERNOON Breakout Sessions (CONTINUED)

3:30 pm - 4:45 pm

SYM: Symposium

RT: Roundtable

SYM-ST: Symposium-Student Track

RT-ST: Roundtable-Student Track

PR: Paper

RT-Workshop: Roundtable-Workshop

SYM	<p>The Complexity of Acculturation's Role in the Educational Persistence of Latino Students</p> <ol style="list-style-type: none"> 1. The Influence of Acculturation and Enculturation on Mexican American High School Students' Decision to Apply to College 2. The Influence of Acculturation on Mexican American College Students' Academic Self-Efficacy, College Outcome Expectations, Academic Goals, and Academic Satisfaction 3. The Influence of Cultural Congruity and the Acculturation Process on the Perception of the University Environment Among Latino College Students 	<p>Chair: Linda Castillo Discussant: Lisa Y. Flores</p> <ol style="list-style-type: none"> 1. Linda Castillo 2. Lizette Ojeda and Lisa Y. Flores 3. Miguel Ángel Cano, Araceli López-Arenas, & Linda G. Castillo 	San Pedro
------------	---	---	------------------

SYM	<p>Child Psychotherapy Residence Program: Assisting Children and Their Families' Socioaffective Wellbeing</p> <ol style="list-style-type: none"> 1. "Mom, I don't want to go the school": Case Study of a 8-year-old Girl with School Phobia 2. Psychotherapeutic Intervention with a Maltreated 8-year-old Girl 3. The Client-Centered Play therapy with a 7-year-old Boy with Learning Problems: A Case Study 	<p>Chair: Ma. Faye Esquivel Ancona</p> <ol style="list-style-type: none"> 1. Claudia Patricia Chávez González 2. Meytal Israel Dwek 3. Marisol Mendoza Téllez Girón 	San Marcos
------------	--	--	-------------------

SYM	<p>Latino's Men Health: Recommendations for Culturally Competent, Empirically-Supported, and Multisystemic Interventions</p> <ol style="list-style-type: none"> 1. Introduction to Latino Men's Health & Theoretical Frameworks 2. Psychological Interventions 	<p>Chair: Anthony Isacco</p> <ol style="list-style-type: none"> 1. Anthony Isacco 2. Timothy E. Rogers 	San Juan
------------	--	--	-----------------

Saturday, AFTERNOON Breakout Sessions (CONTINUED)

3:30 pm - 4:45 pm

SYM: Symposium

RT: Roundtable

SYM-ST: Symposium-Student Track

RT-ST: Roundtable-Student Track

PR: Paper

RT-Workshop: Roundtable-Workshop

SYM	<p>Increasing Participation of Latinos and Native Americans in Scientific and Technical Fields: The Experience of The Society for Advancement of Chicanos and Native Americans in Science (SACNAS)</p> <ol style="list-style-type: none"> 1. Programs and Persistence for Chicanos and Native Americans in Scientific and Technical Fields: Fixing the Pipeline from Precollege to Professional 2. Is it Working? Evaluating the Effectiveness of the Society for Advancement of Chicanos and Native Americans in Science (SACNAS). 	<p>Chair: Ismana Carney</p> <ol style="list-style-type: none"> 1. Ismana Carney 2. Jack Mills 	San Felipe
------------	---	---	-------------------

SYM	<p>Developing Culturally Appropriate Interventions for Spanish-Speaking Immigrant Parents</p> <ol style="list-style-type: none"> 1. Problem Solving in Latino Families 2. Child Language Brokering and Parent-Child Relationships 3. Familismo, Respeto, and Parenting Stress: An Examination of Latino Cultural Values in Immigrant Latino/a Families 	<p>Chair: Melanie M. Domenech Rodriguez</p> <ol style="list-style-type: none"> 1. Kee J.E. Straits 2. Eliza Torres 3. Melissa R. Donovanick & Melanie M. Domenech Rodríguez 	San Carlos
------------	---	--	-------------------

Poster Session
Saturday, 6:30 pm - 7:30 pm

Location: Terrace Pavilion

At the Crossroads: The Intersection of Neuropsychology Training, Cultural Competence, and the Latino/ a Patient, *Hector Y. Adames*

The Role of Generation Status and Acculturation in the Academic Beliefs and Achievement of Latina/o College Students, *David Aguayo, Keith Herman & Lizette Ojeda,*

Development of Culturally Adapted Psycho-social Treatment Intervention for Latino Adults with Psychosis, *Mayra Anguiano, Veronica Cardenas, Brent T. Mausbach, & Christine McKibbin*

Premarital Cohabitation and Marital Satisfaction among Mexican American Couples in the First Year of Marriage: The Role of Gender and Acculturation , *Maria G. Arredondo, Priscilla Macias, Sonia Villafana, & Donna Castaneda*

The Relationship between Ethnic Identity, Acculturative Stress and Eating Disorders in the Latino Community, *Rosalinda Castillo, Linda Castillo, Miguel A. Cano, & Beatriz Castillo*

A Qualitative Study of Resilient Latina/o College Students, *Javier Cavazos Jr., Michael B. Johnson, Alyssa G. Cavazos, & Luti Vela Gude*

Using Cognitive Behavior Therapy to Elicit Weight Loss with Latina/o Students, *Javier Cavazos Jr., Michael B. Johnson, Iliana Rodriguez, & Maria Hinojosa*

Examining Ethnic Identity, Collective Self-Esteem, and Adjustment to College among Latina/o College Students in the Pacific Northwest, *Alison Cerezo & Cristina Bustos*

The Relationship between Acculturation, Parenting Style, and Adherence to Traditional Cultural Values Among Parents of Mexican Descent, *Nayeli Chavez*

Examining the Relationships between Latino Ethnic Identity, Cultural Health Beliefs and Practices, and General Health Outcomes for Latino Adults, *Shannon Chavez-Korell, Jesus Calvillo, Soumya Palreddy, Maureen White, Amileah Davis-Stribling, Jane Liu, Dayna S. Ramstack, Shelly Komondoros, Ling-Lun Chien, & Rhett Engelking*

“¿Quién Soy Yo?” Exploring Ethnic Identity as a Means to Academic Achievement: A Workshop Targeting 1st Year Latino Undergraduate Students, *Arturo Corrales*

Examining Psychosociocultural Effects of Latina Sororities on Academic Persistence Decisions, *Marla Delgado & Alberta M. Gloria*

Success among Latina Adolescents: Definitions, Perceptions, and Connections, *Lisa M. Edwards, Brittany Barber, Shirley Newcomb, Marisa Green, Keyona Jarrett, & Amy E. Kowalski*

(continued next page)

Poster Session (CONTINUED)
Saturday, 6:30 pm - 7:30 pm

Location: Terrace Pavilion

Examining Race-Related Stress and Skin Color amongst Latinos, *Milton A. Fuentes, Daniel Cruz, Caitlin O'Connor, & Vivian Acosta*

Latino Peer Group Self-Identification and Smoking: An Overview of Studies Exploring Smoking and Identification with Peer Groups, *Juliana Fuqua, Jennifer Unger, Dennis Trinidad, & Erika DeJonghe*

Relationship of School Counselor's Multicultural Training to Multicultural Competence, *Michele R. Guzmán, Chris McCarthy, Nicolina Calfa, & Valerie Van Horne Kerne*

Immigration and life satisfaction of Latin American adolescents in Spain, *Brian P. Jacoby, Sonsoles Calderon, & Brian Phillip Jacoby*

Culturally-Targeted Framework for Improving Body Image and Eating Pathology in College-Aged Latina Women, *Gabriela L. Juarez & Lisa Sanchez-Johnsen*

Analyzing Latino Racial Perceptions and Contact with Asians: A Mixed-Methods Approach, *Eric Kohatsu, Michelle Flores, Rudolfo Victoria, Jason Vasquez, Patricia Perez, & William Concepcion*

Recognizing, Understanding, and Treating Mental Health Needs in Latino Men and Women in a Culturally-focused Residential Addiction Treatment Setting, *Wilfred Labiosa, Rick Quiroga, Emily Stewart, Diane Rosado, Maryann Amodeo, Deborah Chassler, Lena Lundgren, & Josefina Irigoyen*

Hablemos Español, Closing the Gap: The Dr. Cynthia Lucero Latino Mental Health Program at Massachusetts School of Professional Psychology, *Amaro Laria, George Soto, Jeanine Baillie, Aimee Asgarian, Zack Blumkin, Christina Massari, & Juan Rodriguez*

Reaching Out to a New Generation of Latino Students: An Introduction to a New Integrative Systems Counseling Theory of Leadership, *Eunice Lerma, Niki Gonzalez, & Michelle Duran*

Socio-Cultural Adaptation of Group Cognitive-Behavioral Therapy for Distressed Latina Immigrants in the U.S., *Andrea Marie Letamendi, Karla Espinosa de los Monteros, & Monica D. Ulibarri*

Intragroup Marginalization Among Latino College Students, *Jasmin Llamas*

Determinants of Resilience and Acculturative Stress among Undocumented Mexican Immigrants, *Susana Ayala Lopez & Lisa Inez Sweatt*

Depression, Anxiety, and Marital Satisfaction among Mexican American Couples in the First Year of Marriage, *Marisa Luna & Donna Castaneda*

The Impact of Ethnic Identity on Parent-Child Relationships, *Kathryn Margolis, Cindy Huang, & Beth Stormshak*

Poster Session (CONTINUED)
Saturday, 6:30 pm - 7:30 pm

Location: Terrace Pavilion

Violence against Women in Latino Communities: Trends and Services, *Ana Patricia Martinez, Oksana Yakusko, & Nancy Bowen*

Que Dios Nos Ayude: Spirituality as a Source of Coping for Latino/as in the U.S., *Vanessa L. Martinez & Brian W. McNeill*

The Effects of Psychosociocultural Constructs on the Quality of Mentoring Relationships with Latina/o Undergraduates: A Qualitative Study, *Cynthia Medina, Jeanett Castellanos, & Alberta M. Gloria*

Latina/o College Students: The Positive Influence of Ethnic Identity on Career Decision Self-Efficacy, the Perception of Career Barriers, and Coping Efficacy, *Brenda X. Mejia, Rachel L. Navarro, & George V. Gushue*

Oh No, Divorcio in My Family! Impact of Acculturation on Latina/o Clients Considering Divorce, *Nely Meza & Patricia Van Velsor*

Religious Practices of Latino Immigrants Experiencing Acculturation Stress, *Melvin Navarro*

Spirituality and Psychology: The Use of Narrative Therapy and Latino Folk Traditions, *Ivonne Ocampo & Lorena Muñoz*

Parenting Styles and Socioeconomic Status in a Mexican Sample, *Monica Ochoa & Melanie M. Domenech Rodriguez*

Caring for Sexually Abused Children: A Phenomenological Study of the Experience of a Latina Mother, *Shawne Stacie Ortiz*

Conducting a Parenting Group with Spanish-speaking Fathers, *Ana Lydia Peeks*

A Phenomenological Case Study of Bilingual Training Practices, *Liliana Pizaña & Carrie Castañeda-Sound*

Correlations and Divergence of US ESCR Norms and Spanish Language Rorschachs: A Mexican University Sample, *Alex Renelt, Deisy Boscan, Lynne Saba, & Nolan Penn*

Developmental Expectations in a Mexican Sample: Relationship to Family Characteristics and Child Outcomes, *Spencer Richards & Melanie M. Domenech Rodriguez*

Spanish Language Enhancement Association for Therapists: Developing Bilingual Therapists for Culturally-Competent Work, *Jaclyn Riffert, & Susan R. Hall*

The Correlation between Acculturation Status and Cardiovascular Health, *Maria Antonia Rodriguez, Sundar Natarajan, Sonia Suchday*

(continued next page)

Poster Session (CONTINUED)
Saturday, 6:30 pm - 7:30 pm

Location: Terrace Pavilion

Cultura es Fuerza: The Role of Latino Cultural Values in Mexican American College Students',
Rocio Rosales

Latino Artist-Educators in South Florida and their Role in Building and Sustaining Authentic Democratic Spheres, *Deborah Teresita Woeckner Saavedra*

Effects of Ethnic Identity, Acculturation, and Familismo on Health Outcomes of Latino Elders,
Azara Santiago-Rivera, Shannon Chavez-Korell, William Reyes, Roseanne Illes, Talia DeRose, Gregory Benson, Soumya Palreddy, Melissa Rico, & Ernesto Lira

Impact of Gender and Age on Familismo and Acculturation: An Exploratory Investigation,
Azara Santiago-Rivera, Shannon Chavez-Korell, Gregory Benson, Talia DeRose, Roseanne Illes, Ernesto Lira, Soumya Palreddy, William Reyes, & Melissa Rico

Exploring the "Maria Paradox": Examining the Influence of Marianismo and Womanist Identity on Academic Persistence,
Andrea Salazar, Alberta M. Gloria & Eric Kohatsu

Latinos' Self-Disclosure and Collectivism in Intra- and Intercultural Friendships and Acquaintanceships,
Audrey L. Schwartz

Ethnic Identity, Acculturation, and Psychosocial Functioning among Latino Adolescents,
Marsha Tafoya & Renee V. Galliher

After the Fall from Grace: Negotiation of New Identities among HIV-Positive Women in Peru,
Dellanira Valencia-Garcia, Helene Starks, Lara Strick, & Jane M. Simoni

Predictors of Sexual Satisfaction among Mexican American Couples in the First Year of Marriage,
Edgar Vargas, Felisia Diaz, Elsa Carrasco, & Donna Castaneda

'Madres Militares' Support Group: An Exploration of Latina Community Healing and Culturally Based Coping Skills for Military Mothers, *Eugenia L. Weiss*

Conference Schedule at a Glance Sunday, November 16th

6:00 am - 7:00 am	Morning Vinyasa Yoga (all levels) with Pia Kanekoa	Executive Board
		Rm.
7:00 am – 8:00 am	NLPA Executive Committee Meeting	Segerstrom Room
8:00 am - 8:30 am	Breakfast	Plaza Ballroom
8:00 am - 4:00 pm	Exhibit Hall Open	Terrace Pavilion
8:30 am - 8:40 am	Blessing and Renewal Joseph M. Cervantes, Ph.D., ABPP President, NLPA	Plaza Ballroom
8:40 am - 9:25 am	Special Event II—Altered States, Healing and Psychotherapy Richard Yenson Perez-Venero, Ph.D. Donna Dryer Perez-Venero, M.D., MPH, FRCPC	Plaza Ballroom
9:15 am - 9:30 am	Break	
9:30 am - 10:45 am	Morning Breakout Sessions (refer to pages 30-31 for topics and room assignments)	
10:45 am - 11:00 am	Break	
11:00 am - 12:15 pm	Mid-Day Breakout Sessions (refer to pages 32-33 for topics and room assignments)	
12:15 pm - 12:30 pm	Break/Lunch Check-In	
12:30 pm to 1:30 pm	Lunch Keynote Address, Spirituality, Counseling and People of Color Thomas Parham, Ph.D. Vice Chancellor for Counseling and Health Services & Adjunct faculty member, University of California, Irvine	Plaza Ballroom
1:30 pm - 2:30 pm	Town Hall Meeting	Plaza Ballroom
2:30 pm - 3:30 pm	Special Event III—Roundtables (refer to page 34 for topics and room assignments)	
3:30 pm - 3:45 pm	Break	
3:45 pm - 4:45 pm	Special Event IV—Roundtables (refer to page 35 for topics and room assignments)	
4:45 pm - 5:00 pm	Break	
5:00 pm	Exhibits Close	
5:00 pm - 5:30 pm	Assessment and Evaluation of Conference	
5:30 pm - 6:00 pm	Closing Ceremony—2008 NLPA Conference	

Sunday, MORNING Breakout Sessions 9:30 am - 10:45 am

SYM: Symposium

RT: Roundtable

SYM-ST: Symposium-Student Track

RT-ST: Roundtable-Student Track

PR: Paper

RT-Workshop: Roundtable-Workshop

SYM	Hot Ethical Topics (3-Hour Presentation: Continued to Next Session)	Lynda D. Field, Melba Vasquez, Melanie Domenech Rodriguez, & Stephen Behnke	Mesa Verde
SYM-ST	Attending Conferences: How to Prepare and Present	Roseanne Illes, David Acevedo-Polakovich, & Laura Lara	Lido
SYM-ST	Funding: How to Access Financial Resources	Lucas Torres, Lisa Sanchez-Johnsen, & Veronica Bordes	China Cove
SYM	Issues of the Training and Preparation of Latina/o Psychologists in the United States and Latin Countries <ol style="list-style-type: none"> 1. Mapping Latina/o Psychology Faculty 2. Spanish-speaking Mental Health Professionals Experience of Language, Training and Burnout 3. The Psychology Preparation and Training of Latina/o Psychologists in Latin Countries 	Chair: Edward A. Delgado-Romero <ol style="list-style-type: none"> 1. Dominique Broussard 2. Stephanie D. Clouse 3. Marta J. Gonzalez <p>Discussant: Patricia Arredondo</p>	Monarch Bay
PR	<ol style="list-style-type: none"> 1. A Comparative Study of End-of-Life Planning by Mexican-American and European-American Older Adults 2. Culturally Rooted Differences and Approaches to Negotiation in Latino-White Couples 3. Behavioral Acculturation and Latino Life Satisfaction 	<ol style="list-style-type: none"> 1. Rosemarie L. Macias, David Espino, Arthur E. Hernandez, & Robert Wood 2. Elisaida Mendez & Melanie Domenech Rodriguez 3. Silvia L. Mazzula 	San Diego
PR	<ol style="list-style-type: none"> 1. Psychosocial Strategies to Facilitate Provision of Craniofacial Team Services to Latino Families 2. Culturally Specific Treatment for Partner Abusive Latino Immigrant Men: A Qualitative Study to Identify and Implement Program Components 	<ol style="list-style-type: none"> 1. Alexis Johns & Laura Garcia 2. Christauria G. Welland 	San Pedro

Sunday, Morning Breakout Sessions (CONTINUED)

9:30 am - 10:45 am

SYM: Symposium

RT: Roundtable

SYM-ST: Symposium-Student Track

RT-ST: Roundtable-Student Track

PR: Paper

RT-Workshop: Roundtable-Workshop

- | | | | |
|-----------|--|---|-------------------|
| PR | <ol style="list-style-type: none"> 1. Latino/a Identity Orientations: Towards a Dynamic and Developmental Perspective 2. Latino Conversations: Parent and Peer influences on Ethnic Identity and Future Academic Goals | <ol style="list-style-type: none"> 1. Bernardo M. Ferdman & Plácida V. Gallegos 2. Elvia Lorena Navarro, Gabriela Chavira, & Rachel Navarro | San Marcos |
|-----------|--|---|-------------------|

- | | | | |
|------------|---|---|-----------------|
| SYM | <p>Counseling Psychology and Latino/a Studies: Current Partnerships and Future Directions</p> <ol style="list-style-type: none"> 1. Counseling Health Psychology and Latino/a Studies: Opportunities and Rewards 2. Educational and achievement issues in Chicana/o Latina/o Studies and Counseling Psychology 3. Bridging Latino Studies and Counseling Psychology: Latino Mental Health Issues | <p>Co-Chairs: Loreto R. Prieto & Lydia P. Buki</p> <ol style="list-style-type: none"> 1. Lydia P. Buki 2. Alberta M. Gloria 3. Azara Santiago-Rivera | San Juan |
|------------|---|---|-----------------|

- | | | | |
|------------|---|---|-------------------|
| SYM | <p>Mentoring Latino College Freshman: Outcomes and processes</p> <ol style="list-style-type: none"> 1. The Impact of Mentoring at-risk Latino Freshman 2. Effect of Mentor-Mentee Contact on Relationship 3. The Role of Empathy in Mentees' Satisfaction and Perceived Help | <p>Chair: Anita Mihecoby</p> <ol style="list-style-type: none"> 1. Anita Mihecoby 2. Jason Wang 3. Chami Kim | San Felipe |
|------------|---|---|-------------------|

- | | | | |
|------------|--|--|-------------------|
| SYM | <p>Integrating Professional and Cultural Identity through Clinical Supervision</p> | <p>Brenda X. Mejia, Lucinda Bratini, & Fred Millan</p> | San Carlos |
|------------|--|--|-------------------|

- | | | | |
|------------|--|---|--------------------|
| SYM | <p>Survey Results Regarding Use of Specific Psychological Tests by Latino/a Psychologists for Latinos/as</p> | <p>Eduardo Morales and Members of NLPA Task Force on Testing, Measurements, and Assessment of Latinos</p> | San Gabriel |
|------------|--|---|--------------------|

Sunday, MID-DAY Breakout Sessions
11:00 am - 12:15 pm

SYM: Symposium

RT: Roundtable

SYM-ST: Symposium-Student Track

RT-ST: Roundtable-Student Track

PR: Paper

RT-Workshop: Roundtable-Workshop

SYM	Hot Ethical Topics (3-Hour Presentation: Continued from Previous Session)	Lynda D. Field, Melba Vasquez, Melanie Domenech Rodriguez, & Stephen Behnke	Mesa Verde
PR	<ol style="list-style-type: none"> 1. Ethical Considerations in Community-Based Participatory Research 2. A Guatemalan Adventure: Developing and Implementing a Counseling Psychology Ph.D. Program that is Rooted in a Nation's Reality – Process and Implementation 3. Can Standardized Psychoeducational Test Data Ever Be Useful When Evaluating the Culturally and Linguistically Diverse?: The Case for the Cross-Battery Assessment Approach 	<ol style="list-style-type: none"> 1. Michelle Cruz-Santiago 2. Melissa L. Morgan, Manuel J. Casas, & Marisela Lopez 3. Maryann Santos de Barona 	Lido
PR	<ol style="list-style-type: none"> 1. Predicting Latinas' Career Choice Traditionality: The Role of Identity, Barriers, and Coping 2. The Influence of Acculturative Stress on Academic Persistence among Latino College Students 3. Factors Affecting Persistence in First-Year Undergraduates 	<ol style="list-style-type: none"> 1. Rachel L. Navarro, Sarah K. Tamminga, Nadia Cano, & Laura Luna 2. Araceli Lopez-Arenas, Miguel Ángel Cano & Linda G. Castillo 3. Arthur Manjarrez 	China Cove
SYM	Public Policy and Practice Issues in Mental Health with Latina/os: Overview of State and National Efforts and Strategies for Creating Change.	Henry Acosta	Monarch Bay
SYM	Challenges In Providing Psychological Evaluations To Detainees at The Northwest Detention Center	Claudette S. Antuña & Beverly Underwood	San Diego
SYM	The Children Cried and Nobody Listened: Officially-sanctioned Victimization of Undocumented Immigrants—The New Bedford Case	Presenters: Amaro Laria, Jeanine Baillie, & George Soto	San Pedro
SYM	I Shouldn't Need to Press '1' for English: Racism as a Traumatic Event in Latino/a Clients	Héctor L. Torres & Anita O'Connor	San Marcos

Sunday, MID-DAY Breakout Sessions (CONTINUED)

11:00 am - 12:15 pm

SYM: Symposium

RT: Roundtable

SYM-ST: Symposium-Student Track

RT-ST: Roundtable-Student Track

PR: Paper

RT-Workshop: Roundtable-Workshop

SYM	<p>Language Brokering: New Developments in Research</p> <ol style="list-style-type: none"> 1. Language Brokering in Mexican Families Living in the Midwest 2. A Preliminary Model for Understanding the Language Brokering Experiences of Latinas 3. Latina/o Language Brokers in College: A Qualitative Study 4. Reflections of a Latino Language Broker 	<p>Chair: Alejandro Morales</p> <ol style="list-style-type: none"> 1. Alejandro Morales 2. Carrie Castaneda-Sound 3. Gloria L. Rodriguez 4. David Aguayo <p>Discussant: Raymond Buriel</p>	San Juan
------------	---	--	-----------------

SYM	<p>Helping Latina/o Students Navigate the Pathway to Higher Education and Beyond: Graduate Students' Perspectives on Barriers, Positive Coping, and Mentoring</p> <ol style="list-style-type: none"> 1. Barriers that Prevent Latina/o Students from Pursuing Higher Education and Beyond 2. Positive Coping in Helping Latina/o Students overcome Adverse Experiences 3. The Importance of Mentoring Latina/o Students in Graduate School 	<p>Chair: Luti Vela-Gude</p> <ol style="list-style-type: none"> 1. Luti Vela-Gude 2. Javier Cavazos Jr. 3. Luti Vela-Gude & Javier Cavazos 	San Felipe
------------	---	---	-------------------

RT	<p>Developing Latino Achievement Initiatives in Colleges and Universities: Building Workforce Pipelines</p>	<p>Eduardo Morales & Bernardo Ferdman</p>	San Carlos
-----------	---	---	-------------------

Sunday, Special Events III—Roundtables
2:30 pm - 3:30 pm

SYM: Symposium

SYM-ST: Symposium-Student Track

PR: Paper

RT: Roundtable

RT-ST: Roundtable-Student Track

RT-Workshop: Roundtable-Workshop

RT-ST	Difficult Experiences	Jeanett Castellanos, Manuel X. Zamarripa, & Michelle Cruz-Santiago	Mesa Verde
RT-ST	Navigation to Graduation	Araceli Lopez-Arenas, William Reyes, & Hector Adames	Lido
RT	The Yoruba-Lucumí-Santería Religion: Holistic Well-being for the Latina/o Community	Laura Ortiz Guillén	China Cove
RT	¿Hablas español?: Exploring the Challenges and Benefits of non-Latinos Working with Latinos	Angela D. Ledgerwood, Kee J.E. Straits, & Elisaida Mendez	Monarch Bay
RT	Exploring the Intersections of Work and Family Amongst Latinas	Rosa Moreno-Alcaraz & Susana Salgado	San Diego
RT	Nuestra Cultura: Exploring Our Racial Cultural Identities and the Social Construction of Latinoness	Brenda X. Mejia, Rebecca Rangel, & David P. Rivera	San Pedro
RT-ST	Entre Nos: A Dialogue for Graduate Students to Create Our Space within This Place	Marla Delgado, Tom Chavez, & Gerardo Mancilla	San Marcos
RT	Becoming a Fellow of the American Psychological Association	Edward Delgado-Romero	San Juan
RT	Addressing and Combating Sexism and Racism within Communities of Color: A Difficult Dialogue	Bill Johnston II & Rachel L. Navarro	San Felipe
RT-Wk	Understanding the Importance of Advocacy and the Role of Psychology in Promoting Social Justice (2-Hour Workshop: Continues to Next Session)	Annie G. Toro	San Carlos

Sunday, Special Events IV—Roundtables

3:45 pm - 4:45 pm

SYM: Symposium

RT: Roundtable

SYM-ST: Symposium-Student Track

RT-ST: Roundtable-Student Track

PR: Paper

RT-Workshop: Roundtable-Workshop

RT	Machismo and Marianismo: Research and Implications for Healing and Therapy	G. Miguel Arciniega, Maritza Gallardo-Cooper, Manuel Casas, Patricia Arredondo, & Zoila Tovar-Blank, Alberto Figueroa	Mesa Verde
RT	Teaching Latino psychology: An Interactive Syllabus-Exchange Roundtable	Milton Fuentes, Hector Adames, & Elisa Velasquez Andrade	Lido
RT	Culturally Competent Recruitment of Latino Families and Community Engagement in Research	Mercedes Logan, Anthony Isacco, Madeleine U. Shalowitz, Kim Wagenaar, Elizabeth Clark-Kauffman	China Cove
RT-ST	Apoyando a la Juventud: A Dialogue to Explore Various Programs and Scholarship Opportunities for Latina/o Students to Attend Higher Education.	Gerardo Mancilla	Monarch Bay
RT-ST	Mentors and Hermanitas: Struggles and Triumphs of Latina Graduate Students	Enedelia Saucedo, Claudia V. Porras, & Ilse Carrizales	San Diego
RT	Empowering Spanish Speaking Latino Families: Utilizing Brief Systemic Therapeutic Approaches	Melissa A. Talamantes, Liliana Pizana, Melva Torne Boyd, & Bernadette Solórzano	San Pedro
RT	Agapé Christian Reconciliation Conversations: A Program Addressing Religion and Homosexuality Among Latino/as	Héctor L. Torres & Peter Barbosa	San Marcos
RT	What We Can Learn From Shamanic Healing	Marlene Dobkin de Rios, Ph.D.	San Juan
RT-Wk	Understanding the Importance of Advocacy and the Role of Psychology in Promoting Social Justice (2-Hour Workshop: Continued from Previous Session)	Annie G. Toro	San Felipe



Celebrando Nuestros Logros



NLPA 2008 Awards

The NLPA mission includes:

Generating and advancing psychological knowledge.

Fostering the effective application of psychological knowledge for the benefit of the Latina/o populations.

Contributing to the field of Latina/o psychology.

Promoting the educational and professional advancement of Latina/o psychologists.

Fostering communication with members of Latina/o communities at all levels for their mutual education.

Promoting an awareness of educational and professional issues centered in Latina/o psychologists and mental health practitioners.



CYNTHIA DE LAS FUENTES DISSERTATION AWARD

Alejandro Morales,

University of Nebraska Lincoln

NLPA DISSERTATION RESEARCH AWARD

Tiffany Schiffner,

University of Illinois, Urbana-Champaign

STUDENT SERVICE AWARD

Henry Acosta, MSW

Rutgers School of Social Work

STAR VEGA DISTINGUISHED SERVICE AWARD

Dr. Jeanett Castellanos,

University of California, Irvine

DISTINGUISHED PROFESSIONAL EARLY CAREER AWARD

Dr. Lisa Flores,

University of Missouri, Columbia

and

Dr. Lisa Sanchez-Johnson,

University of Chicago

DISTINGUISHED PROFESSIONAL CAREER AWARD

Dr. Azara Santiago-Rivera,

University of Wisconsin, Milwaukee





Student Scholarship Awardees



David Aguayo, *University of Missouri*
Greg Benson, *University of Wisconsin, Milwaukee*
Veronica Bordes, *Arizona State University*
Jesus Calvillo, *University of Wisconsin, Milwaukee*
Miguel Cano, *Texas A&M University*
Alison Cerezo, *University of Oregon*
Tom Chavez, *University of Wisconsin, Madison*
Stephanie Clouse, *University of Georgia*
Arturo Corrales, *Wright State University*
Michelle Cruz-Santiago, *University of Illinois at Urbana-Campaign*
Marla Delgado, *University of Wisconsin, Madison*
Melissa Donovanick, *Utah State University*
Fernando Estrada, *Arizona State University*
Nallely Galvan, *University of Illinois at Urbana-Campaign*
Marta Gonzalez, *California State University, Northridge*
Roseanne Illes, *University of Wisconsin, Milwaukee*
Laura Lara, *University of Northern Colorado*
Angela Ledgerwood, *Miami University*
Andrea Letamendi, *University of California, San Diego*
Laura Luna, *New Mexico State University*
Johanna Malaret, *Alliant International University*,
Vanessa Martinez, *Washington State University*
Brenda Mejia, *Teachers College, Columbia University*
Diana Naranjo, *Arizona State University*
Elvia Navarro, *New Mexico State University*
Karina Ramos, *University of Missouri*
William Reyes, *University of Wisconsin, Milwaukee*
Maria Antonia Rodriguez, *Yeshiva University*
Tiffany Schiffner, *University of Illinois at Urbana-Champaign*
Amileah Stribling, *University of Wisconsin, Milwaukee*
Marsha Tafoya, *Utah State University*
Maureen White, *University of Wisconsin, Milwaukee*
Deborah Woekner-Saavedra, *University of Albany (SUNY)*

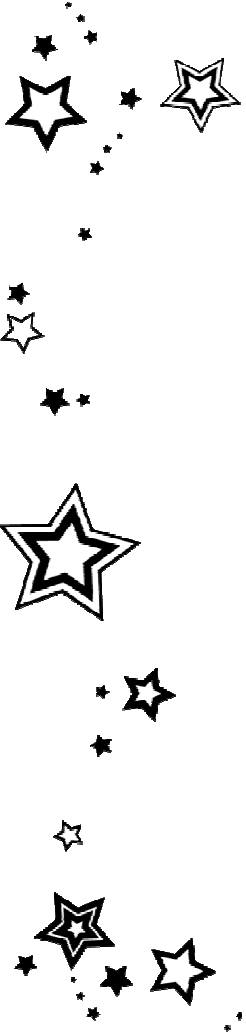

NLPA EXECUTIVE COMMITTEE

PRESIDENT

Joseph M. Cervantes, Ph.D., ABPP
California State University, Fullerton

PRESIDENT-ELECT

Edward Delgado-Romero, Ph.D.
University of Georgia

PAST PRESIDENT

Azara Santiago-Rivera, Ph.D.
University of Wisconsin, Milwaukee

TREASURER & MEMBERSHIP CHAIR

Esteban Cardemil, Ph.D.
Clark University

NEWSLETTER EDITOR

Ignacio David Acevedo, Ph.D.
Central Michigan University

STUDENT & PROFESSIONAL DEVELOPMENT

Shannon Chavez Korell, Ph.D.
University of Wisconsin, Milwaukee

PUBLIC RELATIONS

C. Sonali Gonzalez
University of Wisconsin, Milwaukee

STUDENT REPRESENTATIVE

Roseanne Illes
University of Wisconsin, Milwaukee

HISTORIAN

Marie Miville, Ph.D.
Teachers College, Columbia University

SECRETARY

Lynda Field, Ph.D.
Suffolk University, Boston

EMERITUS PAST PRESIDENT

Patricia Arredondo, Ed.D.
University of Wisconsin, Milwaukee

AMERICAN PSYCHOLOGICAL ASSOCIATION LIAISON

Alberto Figueroa
Washington, D.C.

LISTSERV MANAGER

Edil Torres Rivera, Ph.D.
University of Florida



ACKNOWLEDGEMENTS

CONFERENCE PLANNING

Jeanett Castellanos
Jose Cervantes
Steve Delgadillo
Melissa Felix
Julie Gonzalez (Conference Planner)
Amy Guerrero
Melvin Navarro
Rogelio Serrano

AWARDS COMMITTEE

Ed Delgado-Romero

PROGRAM REVIEW COMMITTEE

Lisa Edwards
Rachel Navarro

SUPPORT COMMITTEE

Pia Kanekoa, Yoga/Meditation Teacher
Michaelann Cervantes, Stand-Up Comedian

CEU COMMITTEE

Milton Fuentes
Jo Linder-Crow

CONFERENCE SPONSORS/EXHIBITORS

California Latino Psychological Association
Empowerment Workshops, Inc.
Microtraining
Our Lady of the Lake University
The Trust
Latinos in Higher Ed
Chicago School of Psychology
Alliant International University
Cal State University, Fullerton
California Teachers Association
California Psychological Association
American Psychological Association, Office of Ethnic Minority Affairs
Southwest Airlines
University of California, Irvine
Cal State University, Bakersfield

STUDENT SUPPORT COMMITTEE

Shannon Chavez Korell
Roseanne Illes





**The American Psychological Association's
OFFICE OF ETHNIC MINORITY AFFAIRS
Is Pleased to Help Sponsor
The 2008 NLPA Conference
We Are Steadfast in Our Support
Of Your Continuing Efforts
To Ensure Diversity in Psychology**

Urban Profile Ad Here



Successfully Matching
Employers and Job Seekers
in Higher Education

Search Our Postings Today!

860.632.7676

www.LatinosinHigherEd.com

***The # 1 Resource for
Latina/o Professionals in Higher Education***

Making a Difference in Our Communities

The California School of Professional Psychology and the Latino Achievement Initiative at Alliant International University are proud to be a sponsor of the National Latino/a Psychological Association 2008 Conference.

**Visit our booth in the exhibit area.
Meet old friends and find out what's new...**

- Learn about the **Undergraduate Psychology Program** offered through Alliant's Center for Undergraduate Education—accepting applications for enrollment year-round.
- Find out what's going on with **CSPP** these days, including our clinical psychology and MFT programs in California and our cultural immersion programs and counseling psychology master's program in Mexico City.
- Learn about the next cohort of our Postdoctoral Master of Science program in **Clinical Psychopharmacology** beginning in January 2009.
- Explore the suite of Web Lectures and the new certificate program in **Post-Combat Behavioral Health** offered through our Continuing Education office and see how convenient and engaging online CE classes can be.
- Find out about upcoming CSPP alumni events, access job postings and get more information about the Alliant Alumni Referral Scholarship through our online social and networking community: www.AlliantConnect.org.

CSPP CALIFORNIA SCHOOL OF
PROFESSIONAL PSYCHOLOGY
ALLIANT INTERNATIONAL UNIVERSITY

www.alliant.edu/cspp

Alliant is a private, nonprofit, WASC-accredited university and an equal opportunity employer and educator.

Westin South Coast Plaza

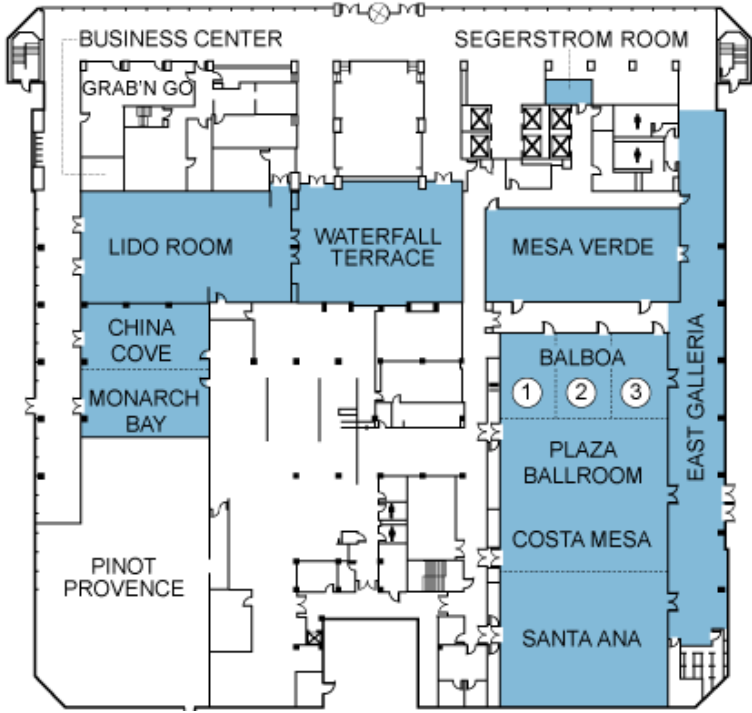

- 1. CAPISTRANO
- 2. LAGUNA
- 3. VIEJO

FIRST FLOOR

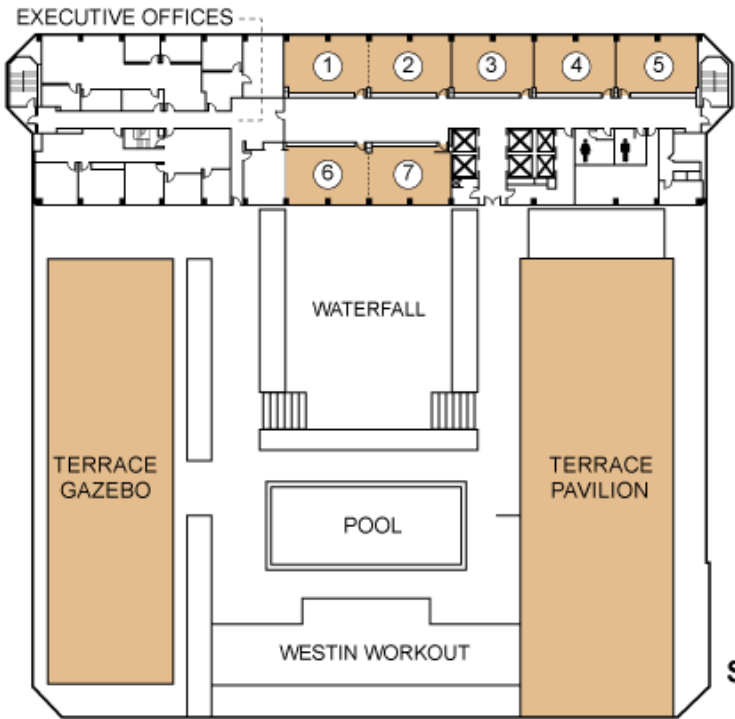

- 1. SAN MARCOS
- 2. SAN JUAN
- 3. SAN FELIPE
- 4. SAN CARLOS
- 5. SAN GABRIEL
- 6. SAN PEDRO
- 7. SAN DIEGO

SECOND FLOOR

- 1. BOLSA CHICA
- 2. CRYSTAL COVE
- 3. DEL MAR
- 4. EMERALD BAY
- 5. EXECUTIVE BOARDROOM

THIRD FLOOR

